

B's Processor Guide

Introduction to rotating base film development.

This guide provides basics and best practices for the use of your new B's processor which are based on our extensive testing. The following recommendations will give most users the best starting point for using our processor. Adjustments might be needed for variations in film stock, chemicals, your lab setup or just your personal preferences. Make only one change at a time and keep notes.

I. Overview

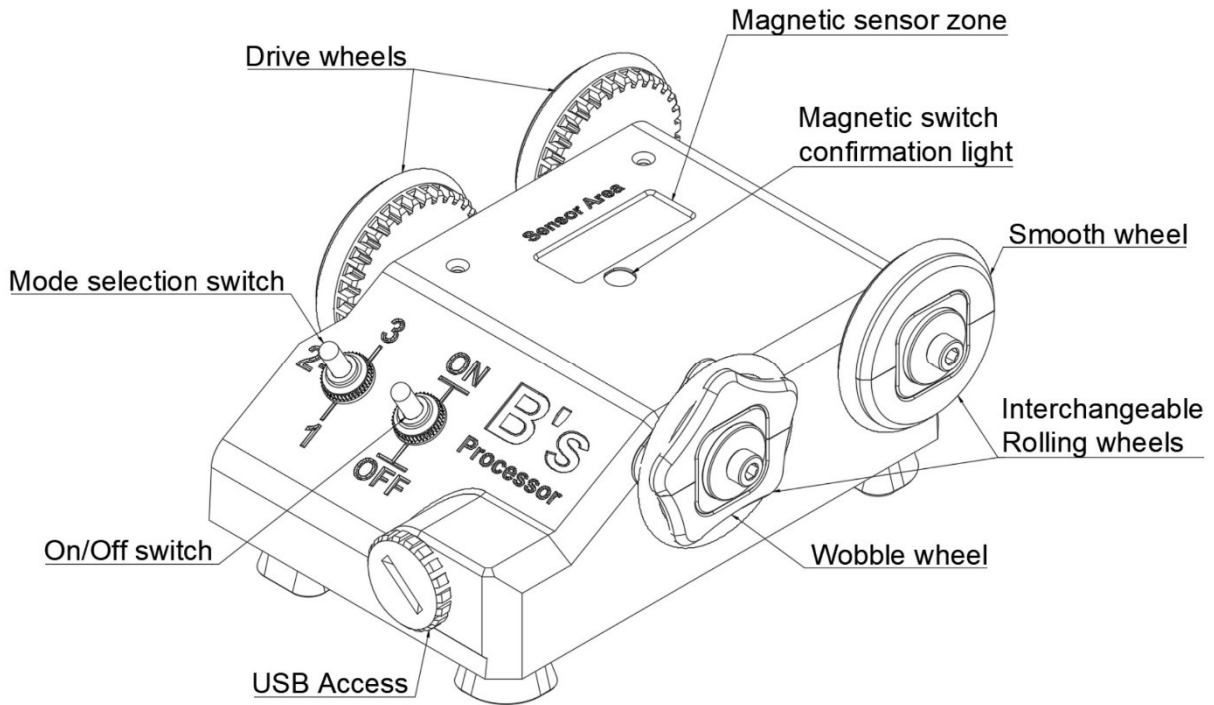

*Wobble and smooth rolling wheels are not meant to be used together; this drawing is only to reference the parts.

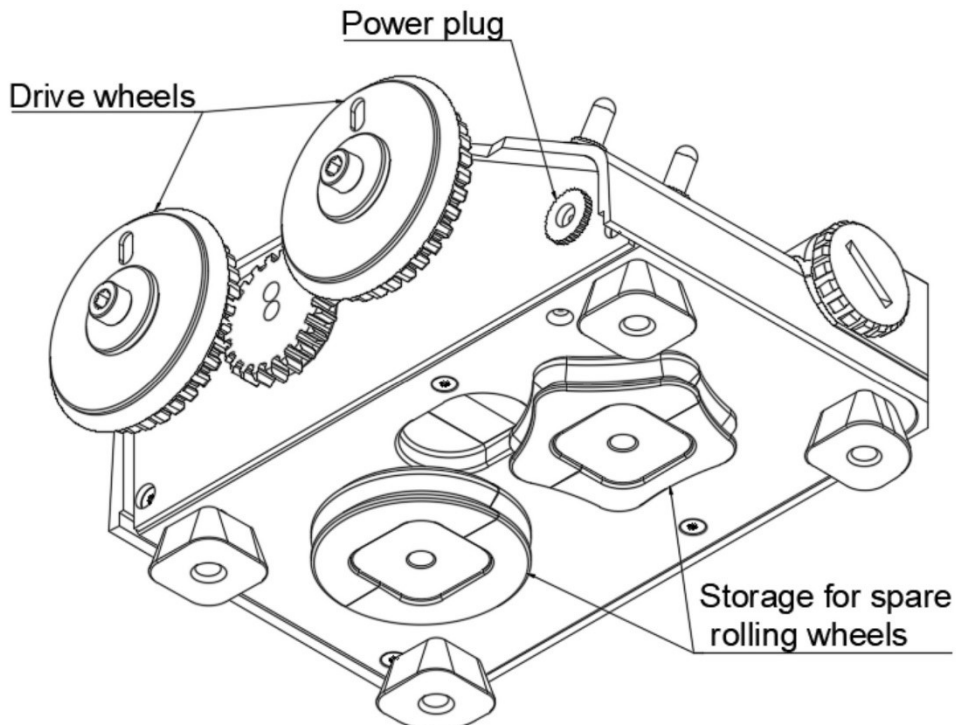

II. Machine settings

- Mode 1 is Pulsed Rotation. (Great for development and fixer if the fast speed is not usable)
- Mode 2 is Slow Rotation, around 10 rpm.
- Mode 3 is Fast Rotation, around 38 rpm. (Great for fixer, limited use with the wobble wheels)

Your processor is also equipped with interchangeable rolling wheels, smooth and wobble. The extra set is stored under the machine. To change it just pull the rubber off, each wheel will split into two pieces, remove them and slide the other set on before replacing the rubber on them. Be careful the wheel's pieces are not symmetrical, and the larger chamfer should be facing out.

It is not recommended to mix the two sets of wheels; it will lead to instability and the possible fall of your tank from the machine.

III. Tank Setup

Step 1: Set the Track.

Refer to this chart and drawing to create the "track" where the drive wheels will ride. This chart was developed for Paterson tanks. If using other tank types, determine track setting using a full tank as empty tanks move due to lack of weight. If the track is set properly, the tank should be balanced on B's processor and not wobble.

Paterson Tank Size	Number of Bands Needed	D
P2	1	4" 1/4 - 105mm
P3	1	5" 3/4 - 145mm
P5	2	8" 1/4 - 210mm
P8	2	11" 1/2 - 290mm

Tank Name	Number of Bands	D

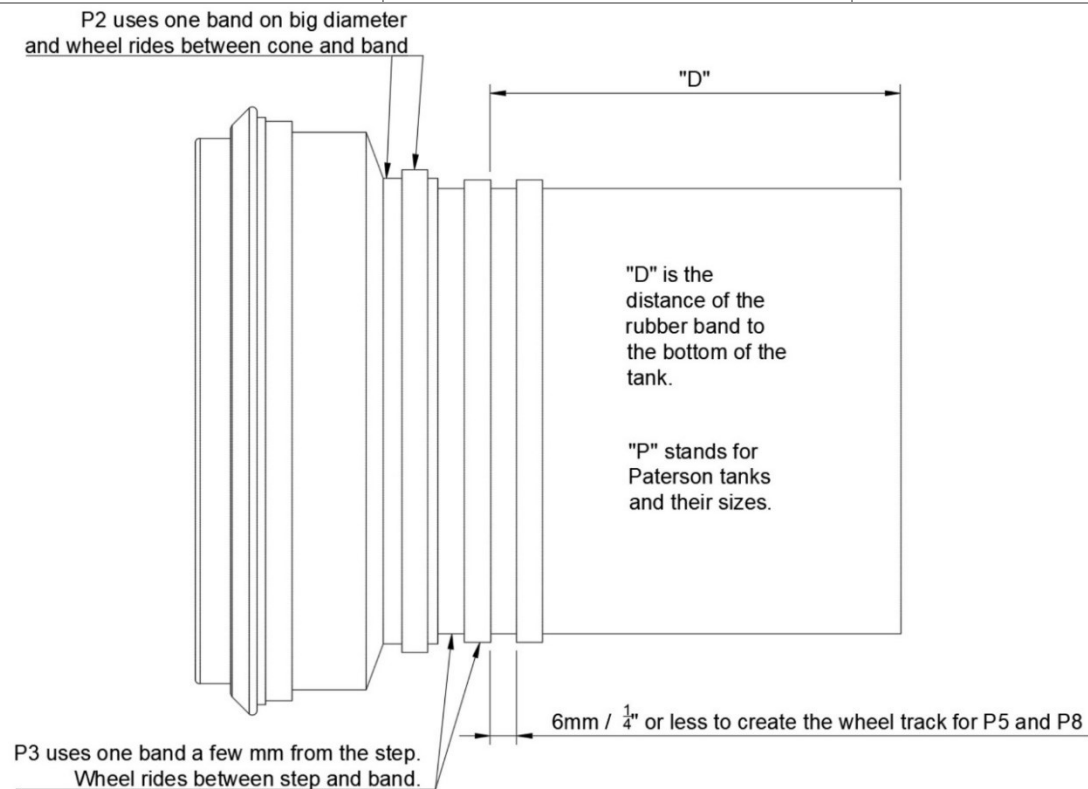

Step 2: Set your magnetic trigger.

Using one more rubber band, add one of your two magnetic triggers to your tank. Position the trigger so its magnets line up with the sensor area on your processor and test its function. The switch confirmation light will indicate if the triggering works properly and should light up every time a trigger magnet passes. Move it up and down your tank until it works properly and reliably. This test is best done with some water in the tank, so the weight is like the real thing.

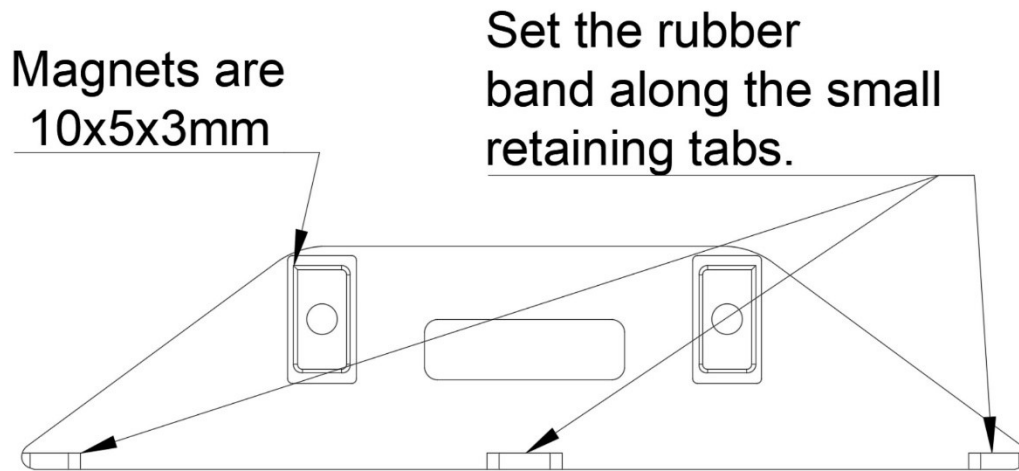

Step 3: Add the reel lock “penguin” to the Paterson column.

Slide the penguin into the bottom of the center column of the Paterson tank, then place the loaded reels and column inside the tank with a slight turn or wiggle until it is seated. Do not force the column into place. It should seat itself.

*Penguin is not necessary with the Paterson one reel tank.

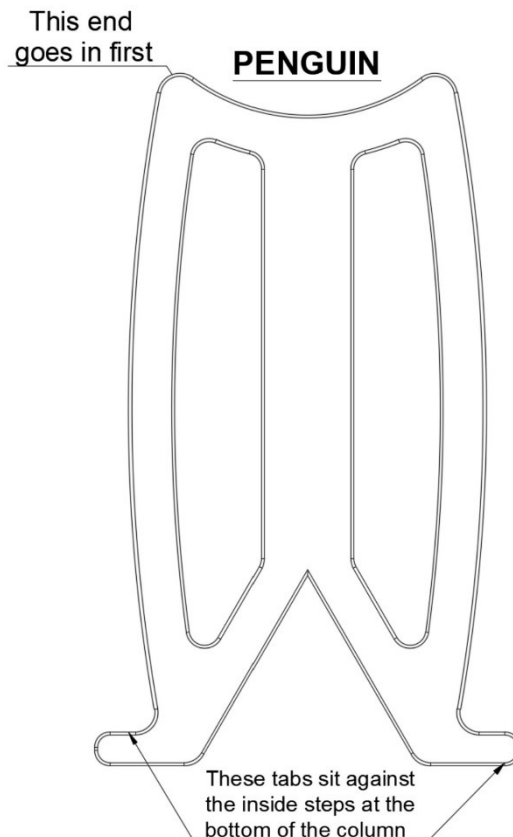
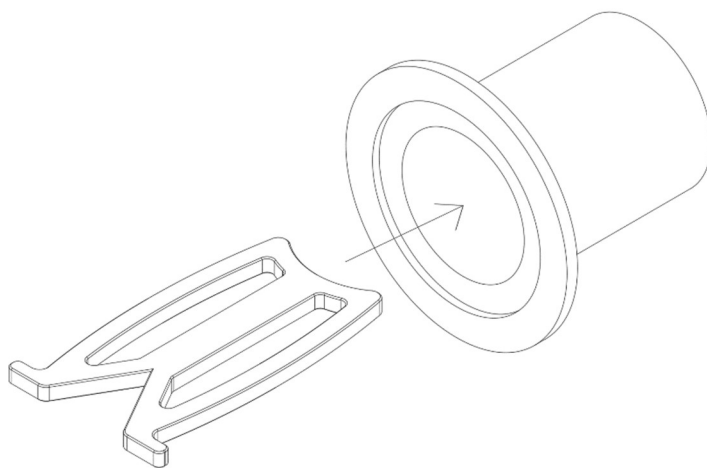

IV. General development recommendations

Use the instructions for the type of chemical you are using as a base and adjust according to the following recommendations:

Pre-warm/ Pre-wash

-Pre-warming and Pre-washing are recommended for all processes, especially for color development.

-The prewarm/prewash step allows the user the opportunity to ensure that the tank is stable and setup properly before the point of no return and adding in the developer. During this step, double check that the magnetic band is triggering the sensor properly, the "track" for the drive wheels is in the correct position and that the tank is rotating in a stable way.

If you are developing with any B's large format reel, do not skip this step and use the recommended pre-wash from your reel's manual.

Prewash/prewarm instructions:

1. Prepare twice the amount of water needed at the proper temperature for your chemical(s).
2. Pour half the water into the tank, place the tank onto your B's processor and rotate in mode 1 or 3 with smooth wheels for 4 minutes.
3. Empty the tank and pour the second half of the water into the tank, place the tank onto B's processor and rotate for one minute.

Development times and machine settings:

If you are using the "Economy" volume of liquid, increase your development times by 10 to 15%.

If you are using the "Quality" volume of liquid use the normal development time to 5% less.

For best development results, set your B's processor to mode 1 (pulsed rotation) using the wobble wheels.

Caution: Wobble wheels are **NOT** recommended for use with larger tanks, (i.e., Patterson 5 or 8) as the machine may become unstable.

Fixing

Use at least the Economy volume of liquid or more.

Mode 3 is best for 5 minutes as the faster rotation helps fix the film thoroughly.

Caution: If you used the wobble wheels for development, Mode 3 may be too fast and make the machine unstable. Smaller tanks may not have this issue.

Using a stop bath or a rinse cycle between developer and fixer allows the user time to change the rolling wheel from wobble wheels to smooth wheels prior to the fixing stage.

Stop bath, rinse and wash cycles.

Mode 1 or Mode 3 is recommended for stop bath, rinse and wash cycles with the use of either smooth or wobble wheels.

V. Additional Information

Make sure your processor is set on a level surface.

If your tank leaks, use B's optional drip tray or place paper towels under the processor to help keep things clean and dry.

CAUTION! B's processor's motor is strong. Keep out of reach of children. Keep your fingers or anything else that could be caught away from the gears.

Even if you are not new to development using a rotating base, please do NOT develop many rolls on your first try. We suggest developing one roll at a time until you are familiar with B's processor.

The RPMs in this guide are measured values for Paterson tanks, smaller tanks will rotate faster and larger ones slower.

Back and forth rotation is recommended; but one way rotation can be achieved by removing the magnetic switch trigger from your tank. During one-way rotation, all Modes 1, 2, and 3 still work the same (pulsed, slow, fast)

In this Guide, mode 2 was not used at all! So why is it there? For one, it is good to know its speed is slower than mode 1's average speed so that is something you can experiment with and I'm confident it will give you great results thanks to its gentle rotation. (Brute force is not always the answer!) Two, the different modes may change in the future and this middle position may end up being used for coming new experimental moves, maybe semi randomized rotations, who knows....

VI. Processor maintenance

- 1- B's processor is "splash proof", but NOT waterproof. Do not submerge it in liquid. Its construction allows it to receive liquid drops on its top without a chance for it to penetrate inside and damage its electronic or mechanical components. Dry any post-processing moisture with a paper towel. Do not clean with any chemicals, always use clean water to wipe residues away. The rare earth magnets used on your tank can be wet without issues.
- 2- Your new processor is equipped with a USB plug for future firmware updates. Occasionally new firmware will be posted for you to download and install on your machine. Please write here you date of purchase so you will know if the firmware posted online is newer than the one on your machine.

Date of purchase: _____

What is included in the box?

- **1x B's processor**
- **1x 12v 1A power adapter**
- **2x pinguins**
- **2x magnetic triggers**
- **6x rubber bands (non-latex #64 bands)**
- **1x Guide**

- **Extra accessories you can get separately**
- **Short tank support**
- **Mini Wheels**
- **Drip tray**
- ***See next page for accessories guide**

**This instruction guide will be updated as needed.
Please check B's processor's product page for the latest.
www.bounetphoto.com/bounet-designs-analog-shop**

Bounet Designs LLC

December 28, 2023

Accessories guide

-Short tank support

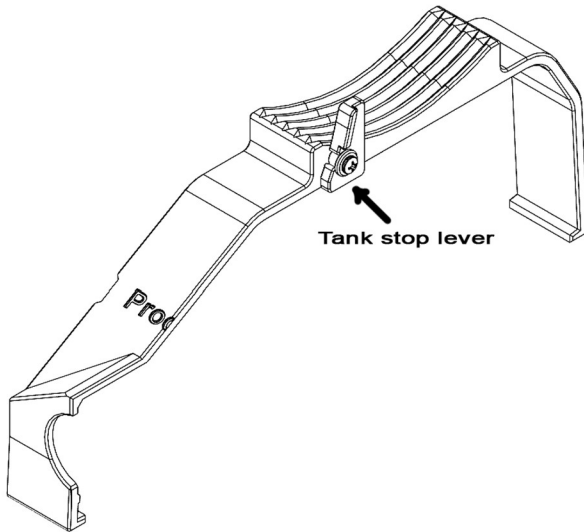

To install, undo the USB access screw, clip the attachment on and screw the hatch back in.

Depending on the tank you use you may need to lift the tank stop lever up.

For example, the Jobo 1510 tank requires it, and the Paterson one reel tank does not.

*The Jobo 1520 also fits nicely on this support.

-Mini Wheels



The mini wheels are a must have to use the Jobo 1540 properly. They are also nice to use with the Paterson 2 and 3 reels. The slight angle given to these tanks allows them to rotate on the processor without the need for a track.